

#### FLOOR TRACKS

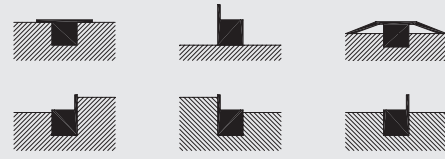

#### CONFIGURATION VARIANTS

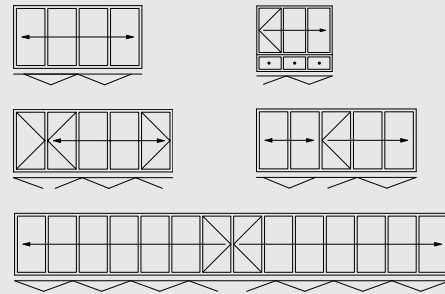

#### VERTICAL SECTION

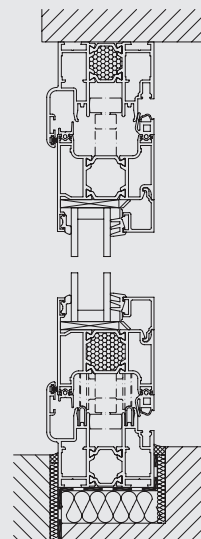

#### PANEL SIZE CHART

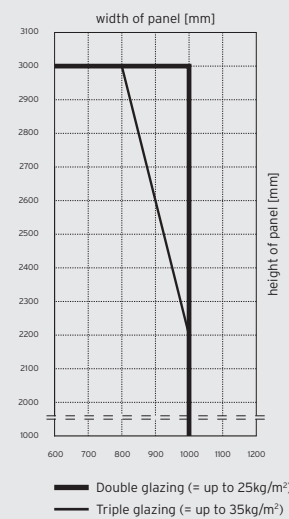

#### SYSTEM

- ▮ Floor mounted (standard) or top-hung folding glass door
- ▮ Panels can be ordered to open either internally or externally, to the left and/or right

#### SYSTEM PROFILE

- ▮ Element thickness 59 mm
- ▮ Narrow frames and panel profiles (panel joint 130 mm)
- ▮ High stability due to tongue-and-groove interlocking panel profile and robust corner joints with thermal insulation
- ▮ Flush floor track without upstand for disabled access available
- ▮ Sealed against wind and rain by double wraparound seal

#### WINDOW/DOOR SYSTEM

- ▮ Complete window system to match the folding glass door is available: tilt and turn, parallel slide and tilt, fixed panels

#### FITTINGS

- ▮ No protruding runner and guide tracks
- ▮ Concealed fittings for one handed operation
- ▮ Lockable in any partly open position

#### GLAZING

- ▮ Heat-insulating glass as standard
- ▮  $U_g = 1,1 \text{ W/m}^2\text{K}$  ( $k = 1,0$ ) with 2 x 4 mm float glass
- ▮ Triple glazing available
- ▮ Glass thicknesses from 5 to 40 mm available

#### SURFACE FINISH

- ▮ Powder coating to RAL
- ▮ Anodised aluminium to EURAS

#### U-VALUE

- ▮  $U_w = 1,10 \text{ W/m}^2\text{K}$

#### MAXIMUM PANEL SIZES

- ▮ Height of panels up to 3000 mm
- ▮ Special sizes on request

#### TESTED FOR

- ▮ Ventilation Class 4 to DIN EN 1026 / 12207
- ▮ Impermeability to rain Class 7A to DIN EN 1027 / 12208 (matches stress group C according to DIN 18 055)
- ▮ Resistance to wind Class B4 to DIN EN 12211 / 12210
- ▮ Long-term functional performance Class 3 to DIN EN 1191 / 12400 (20,000 operations)
- ▮ Burglar resistance RC2 / RC2N to DIN EN 1627:2011



5670206-900 / 09.2012 / subject to technical changes



FOLDING GLASS DOOR  
SL 60e



#### SAFE OPERATION

The swing panel is locked by means of a special catch ensuring the door can be carried along safely.



#### ENGINEERED

Long-lasting stainless steel runners and tracks ensure easy, quiet and smooth operation of the folding glass doors.



#### HEAT INSULATION

Solid multi-chamber profiles with foam core offer the best heat insulation according to the latest energy conservation regulations (EnEV).

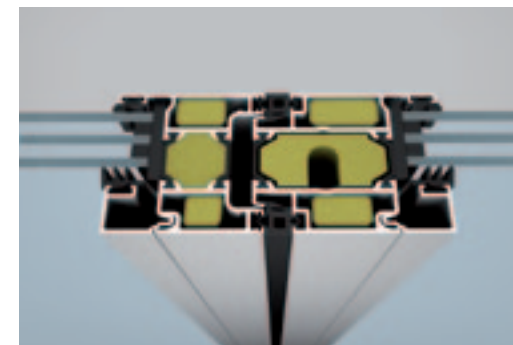

#### CLEANING

The exterior of top hung folding glass doors can be easily cleaned by simply removing the hinge pins.



#### STABILITY

Espagnolettes with 24 mm throw lock the panels into the top and bottom track of the frame ensuring they withstand gales and afford high security.



#### HEIGHT ADJUSTMENT

Even after installation the folding glass door can be easily height-adjusted by about 6 mm - which is important if settling of the building occurs.



#### SECURITY / COMFORT

The integrated multipoint locking system and the comfortable door handle with catch bolt, lock and profile cylinder ensure high security. Certification according to RC2 / RC2N possible.



#### WIDTH ADJUSTMENT

The width of the panels can be altered easily by adjusting the hinges with a screwdriver.

