

## FLOOR TRACKS

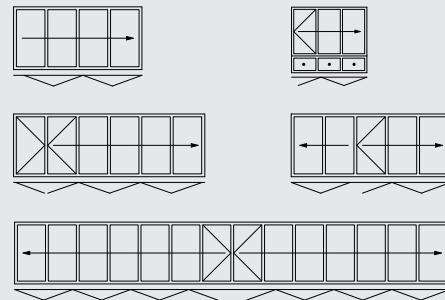

## CONFIGURATION VARIANTS



## SECTIONAL DETAIL

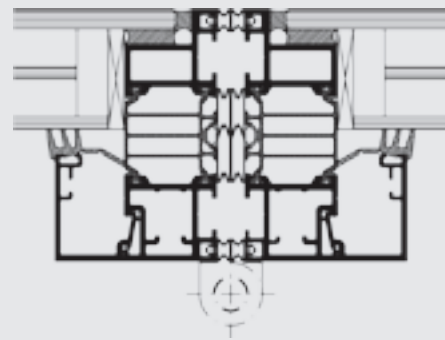

## PANEL SIZE CHART

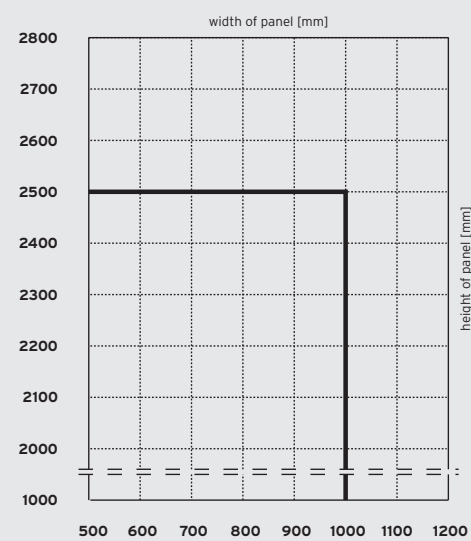

## SYSTEM

- Available as floor-mounted folding glass door
- Can be folded inwards, to the left and/or to the right

## SYSTEM PROFILE

- 80 mm element thickness
- Slim line profile surrounding the glass panes
- Triple wraparound sealing for protection from wind and rain
- The integrated multi-point locking system and the ergonomic door handle with catch bolt, lock and profile cylinder ensure high security
- Opening and closing of the units is also possible from the outside with handles which are bolted through the glass doors and these are lockable using a profile cylinder
- Flush floor track without upstand for barrier free optional

## WINDOW/DOOR SYSTEM

- Can be combined with SL 80/81 window system.
- Modular, fixed and tilt and turn units.

## FITTINGS

- No protruding runner and guide tracks
- Lockable in any partly open position
- Stainless steel runners and tracks ensure effortless sliding action of the folding glass door

## GLAZING

- Layered heat insulated glass
- Triple-glazing available
- Overall thickness of the sealed units 30 to 38 mm
- $U_g = 0,7 \text{ W/m}^2\text{K}$  ( $k = 0,6$ ) with 1 x 6 mm single pane safety glass at the outside, space between panes 12 mm, centre pane 1 x 4 mm float glass, space between panes 12 mm, inside pane 1 x 4 mm float glass

## U VALUE

- $U_w = 1,2 \text{ W/m}^2\text{K}$

## SURFACE FINISH

- Powder coating to RAL
- Anodised aluminium to EURAS

## MAXIMUM PANEL SIZES

- 1000 x 2500 mm
- Panel weight up to 100 kg
- The total element width is unlimited
- Special sizes on request



56702/037-900 / 05.2013 / subject to technical changes



FOLDING GLASS DOOR  
SL 82

 **SOLARLUX**<sup>®</sup>  
glass in motion

 **SOLARLUX**<sup>®</sup>

www.solarlux.com





#### DESIGN

Layered glass overlapping the slim protective surrounding aluminium profile achieve the highly aesthetic quality of an edge-to-edge all-glass system.



#### WIDTH AND HEIGHT ADJUSTMENT

After installation, the panels are easily adjustable in width. Height adjustments of up to 8 mm are also possible to compensate for dimensional inaccuracies in the structure or if settling of the building has occurred.



#### FURNITURE

Concealed corrosion-resistant stainless steel fittings ensure clear profile lines and safety. When the folding glass door is open, the panel stack is compact.



#### BARRIER FREE

A flush floor track without upstand is also available that ensures barrier free living through large openings without a threshold.



#### ENGINEERED

Long-lasting stainless steel runners and tracks ensure easy, quiet and smooth operation of the folding glass doors.



#### SAFE OPERATION

A system integrated stainless steel door handle and the integrated multi-point SL locking system ensure high security.



#### SECURITY

Special espagnolettes with 24 mm throw bolts lock the panels into the top and bottom frame profiles enabling them to withstand gales and provide high security.



#### HEAT INSULATION

Stable multi-chamber profiles with quadruple thermal insulation and double-/triple-glazing provide the best heat insulation after the latest European Energy saving regulations (EnEV).

